

# SIDE CHANNEL BLOWERS

## BX 420 002 – 00/WT – Double Impeller – IE2



Construction of the ring blowers fans is based on the lateral ducts principle. The blowers can operate as either exhaust or compression fans and are designed for continuous service. The device is assembled directly on the motor shaft; all the rotating parts are dynamically balanced to ensure absolute absence of vibration, no contact. Full die-cast aluminum construction for maximum sturdiness and ease of handling. The characteristics data given here refer to the handling of gas with inlet temperature of 15°C, normal density of 1,23 kg/m<sup>3</sup> and absolute pressure of 1023 mbar. Tolerance of ±10%. Max gas inlet temperature 40°.00 standard or WT – Water Treatment – version available.

Model	Freq. [Hz]	Power [kW]	Voltage [V]		Rated Current [A]		Max Airflow [m <sup>3</sup> /h]	Rated VACUUM [mbar]	Rated COMPRESSOR [mbar]	Noise [dB A]	Weight [kg]
			△	Y	△	Y					
BX420 002 016 00/WT	50	1.60	200+240	345+415	7.5	4.3	150	-280	280	66	25
	60	2.05	220+275	380+480	7.6	4.4	180	-320	310	69	
BX420 002 022 00/WT	50	2.20	200+240	345+415	9.7	5.6	150	-330	420	66	27
	60	2.55	220+275	380+480	10	5.8	180	-350	440	69	
BX420 002 M15 00/WT	50	1.50	200+240		9		150	-260	260	66	28
	60	1.75	200+240		9.5		180	-300	290	69	

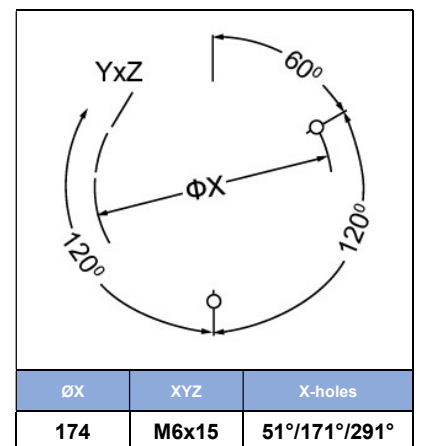
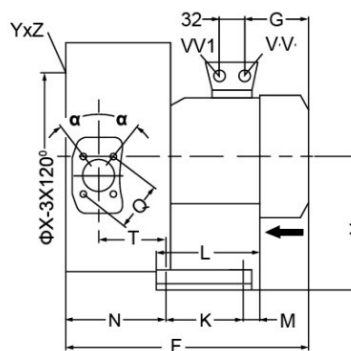
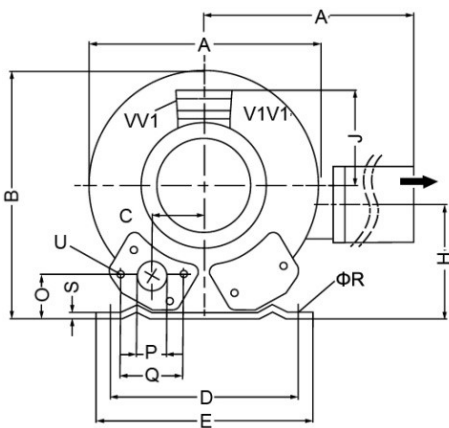
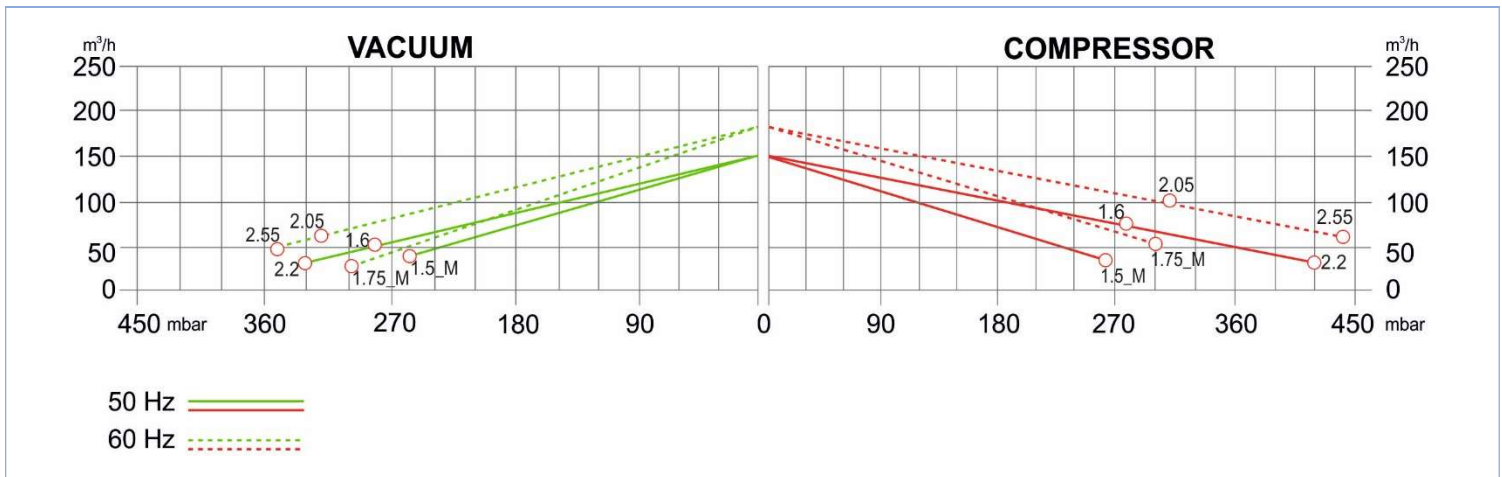

MODEL	A	A'	B	C	D	E	F	G	H	H'	J	K	L	M	N	O	ØP	Q	ØR	S	T	U	(1~)		(3~)		α	
																							V	V'	V	V1'		
BX420 002 016 00/WT																												
BX420 002 022 00/WT	322	324	315	58	225	255	401	191	154	153	128	95	130	73	151	45	G1"½	72	12	3	104	M6x19	-	-	M25X1.5	M16X1.5	28	
BX420 002 M15 00/WT																							M16X1.5	M25X1.5	-	-		

# SIDE CHANNEL BLOWERS

## BX 420 002 – 00/WT – Double Impeller – IE2

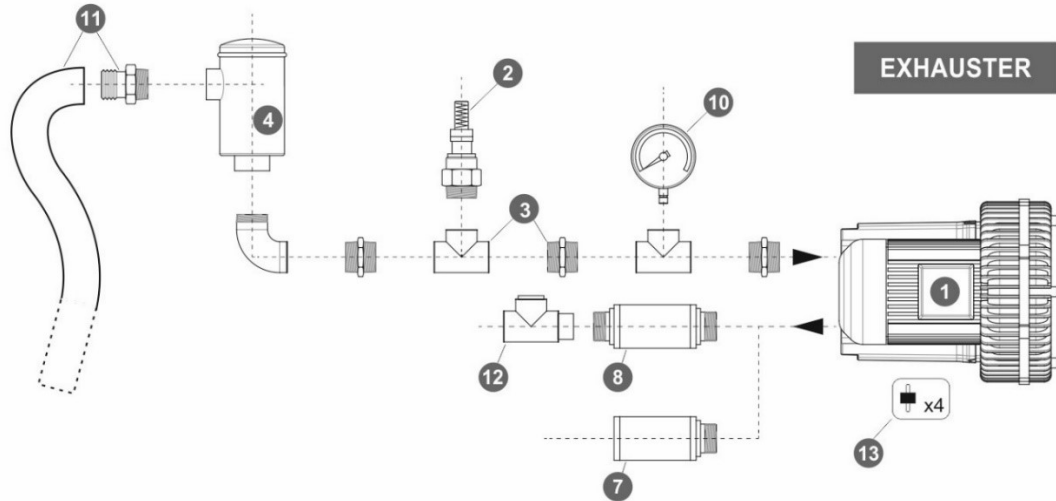

Ref. #	Description	Code
1	Side Channel Blower Double Impeller / Double Stage – Ø1”½ connection	BX 420 002__
2	Safety Valve	BXSV032L03 BXSV032AL36
3	Installation kit safety valve	BXKS032040C
4	In-Line filter	Paper Polyester Stainless Steel 30 µ Stainless Steel 60 µ
5	Cartridge filter	BXCF040PA007
6	Filter kit	Nipple Socket
7	Final Silencer	BXFS040ZP - BXFS040ZPR
8	In-Line silencer	BXIS040
9	Indoor filter	BXIF040ZP100
10	Gauge	BXMN06306 BXVG06306
11	Sleeve + Hose clip kit	BXSH040
12	Check valve	BXCV040AL
13	Anti-vibration pins	BXAV06

