

SIDE CHANNEL BLOWERS

BX 620 002 – 00/WT – Double Impeller – IE2



Construction of the ring blowers fans is based on the lateral ducts principle. The blowers can operate as either exhaust or compression fans and are designed for continuous service. The device is assembled directly on the motor shaft; all the rotating parts are dynamically balanced to ensure absolute absence of vibration. Full die-cast aluminum construction for maximum sturdiness and ease of handling. The characteristics data given here refer to the handling of gas with inlet temperature of 15°C, normal density of 1,23 kg/m³ and absolute pressure of 1023 mbar. Tolerance of ±10%. Max gas inlet temperature 40°. 00 standard or WT – Water Treatment – version available.

Model	Freq. [Hz]	Power [kW]	Voltage [V]		Rated Current [A]		Max Airflow [m ³ /h]	Rated VACUUM [mbar]	Rated COMPRESSOR [mbar]	Noise [dB A]	Weight [kg]
			Δ	Y	Δ	Y					
BX620 002 040 00/WT	50	4	345÷415	600÷720	9.0	5.2	320	-355	375	73	53
	60	4.6	380÷480	660÷720	9.4		385				
BX620 002 055 00/WT	50	5.5	345÷415	600÷720	13.3	7.7	320	-440	500	73	70
	60	6.3	380÷480	660÷720			380				
BX620 002 075 00/WT	50	7.5	345÷415	600÷720	16.7	9.6	320	440	570	73	74
	60	8.6	380÷480	660÷720	17.3		380				

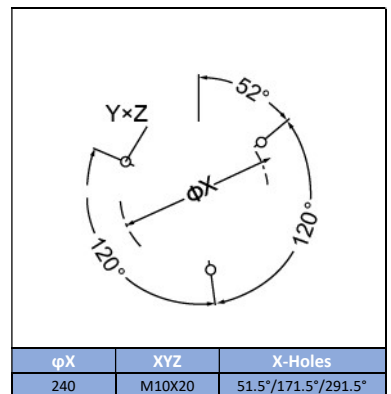
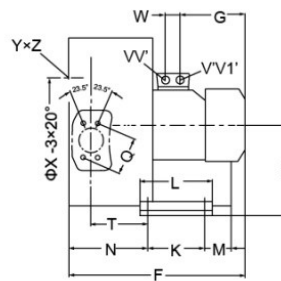
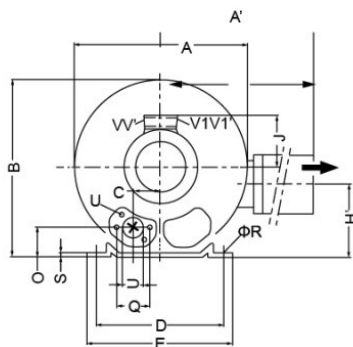
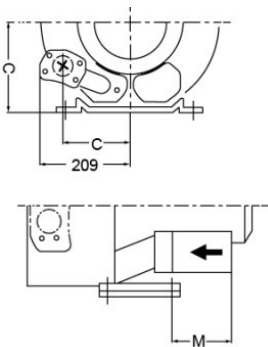
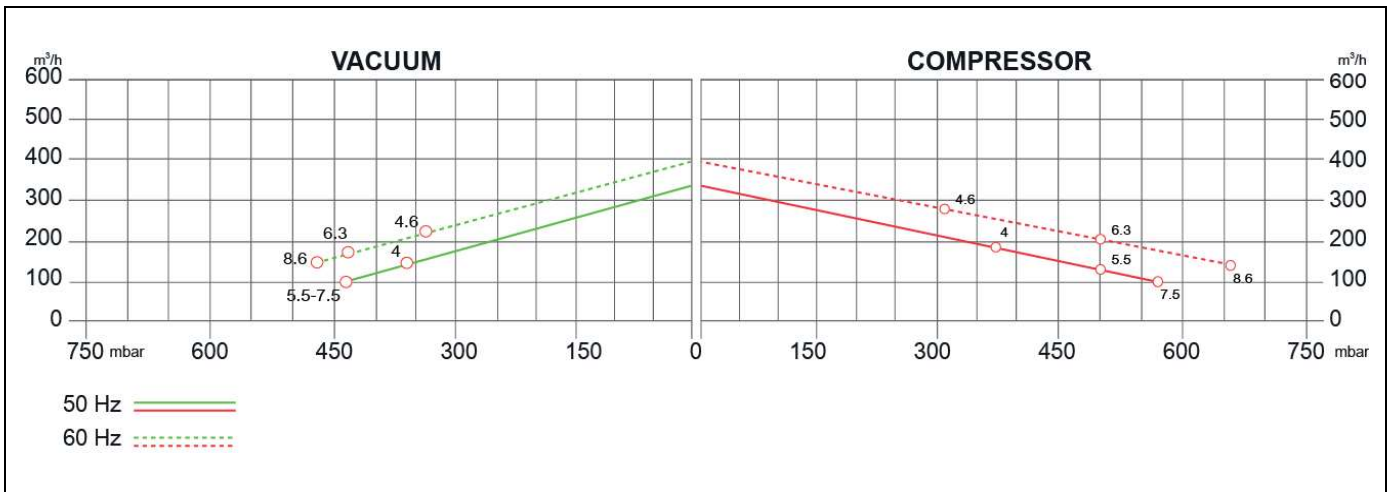

MODEL	A	A'	Bvv	C	D	E	F	G	H	H'	J	K	L	M	N	O	φP	Q	φR	S	T	U	V	V'	V1	V1'	W
BX620 002 040 00/WT	426	426	410	154	290	325			197	162		140	180		205	53	φ2	83	15	4.5	130	M8X17	M32X1.5	M32X1.5	M32X1.5	M32X1.5	42
BX620 002 055 00/WT	426	426	410	154	290	325	571	226	197	162	167	140	180	200	205	53	φ2	83	15	4.5	130	M8X17	M32X1.5	M32X1.5	M32X1.5	M32X1.5	42
BX620 002 075 00/WT	426	426	410	154	290	325	571	226	197	162	167	140	180	200	205	53	φ2	83	15	4.5	130	M8X17	M32X1.5	M32X1.5	M32X1.5	M32X1.5	42

SIDE CHANNEL BLOWERS

BX 620 002 – 00/WT – Double Impeller – IE2

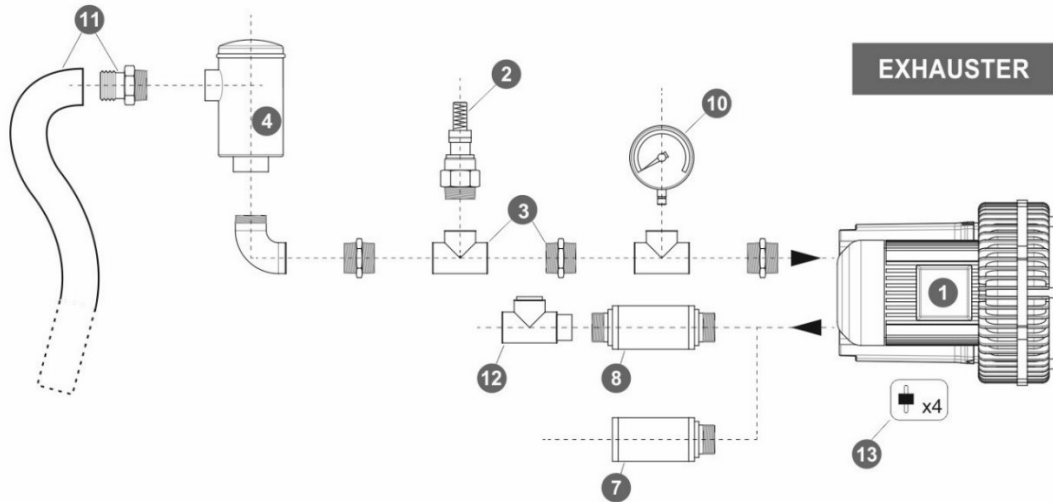

Ref. #	Description	Code
1	Side Channel Blower Double Impeller / Double Stage – Ø2" connection	BX 620 002__
2	Safety Valve	BXSV050AL03
3	Installation kit safety valve	BXKS05F050C
4	In-Line filter	Paper Polyester Stainless Steel 30 µ Stainless Steel 60 µ
5	Cartridge filter	BXCF050PA007
6	Filter kit	Nipple Socket
7	Final Silencer	BXFS050ZP - BXFS050ZPR
8	In-Line silencer	BXIS050
9	Indoor filter	BXIF050ZP100
10	Gauge	BXMN06306 BXVG06306
11	Sleeve + Hose clip kit	BXSH050
12	Check valve	BXCV050AL
13	Anti-vibration pins	BXAV08

