

# SIDE CHANNEL BLOWERS

## BX 620 020 – E3 – Double Impeller – IE3



Construction of the ring blowers fans is based on the lateral ducts principle. The blowers can operate as either exhaust or compression fans and are designed for continuous service. The device is assembled directly on the motor shaft; all the rotating parts are dynamically balanced to ensure absolute absence of vibration. Full die-cast aluminum construction for maximum sturdiness and ease of handling. The characteristics data given here refer to the handling of gas with inlet temperature of 15°C, normal density of 1,23 kg/m<sup>3</sup> and absolute pressure of 1023 mbar. Tolerance of ±10%. Max gas inlet temperature 40°.

| Model            | Freq. [Hz] | Power [kW] | Voltage [V] |         | Rated Current [A] |     | Max Airflow [m <sup>3</sup> /h] | Rated VACUUM [mbar] | Rated COMPRESSOR [mbar] | Noise [dB A] | Weight [kg] |
|------------------|------------|------------|-------------|---------|-------------------|-----|---------------------------------|---------------------|-------------------------|--------------|-------------|
|                  |            |            | Δ           | Y       | Δ                 | Y   |                                 |                     |                         |              |             |
| BX620 020 040 E3 | 50         | 4          | 345÷415     | 600÷720 | 9.0               | 5.2 | 500                             | -150                | 140                     | 74           | 54          |
|                  | 60         | 4.6        | 380÷480     | 660÷720 |                   |     | 600                             | -100                | 90                      | 78           |             |
| BX620 020 055 E3 | 50         | 5.5        | 345÷415     | 600÷720 | 13.3              | 7.7 | 500                             | -240                | 260                     | 74           | 69          |
|                  | 60         | 6.3        | 380÷480     | 660÷720 |                   |     | 600                             | -210                | 200                     | 78           |             |

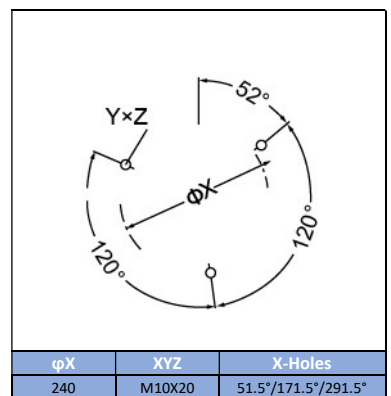
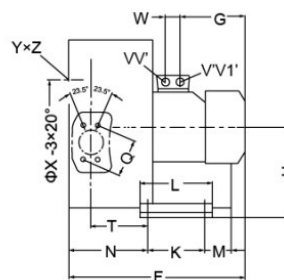
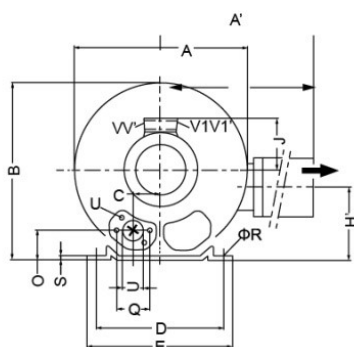
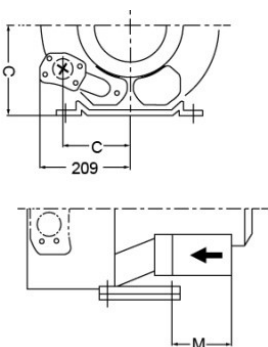
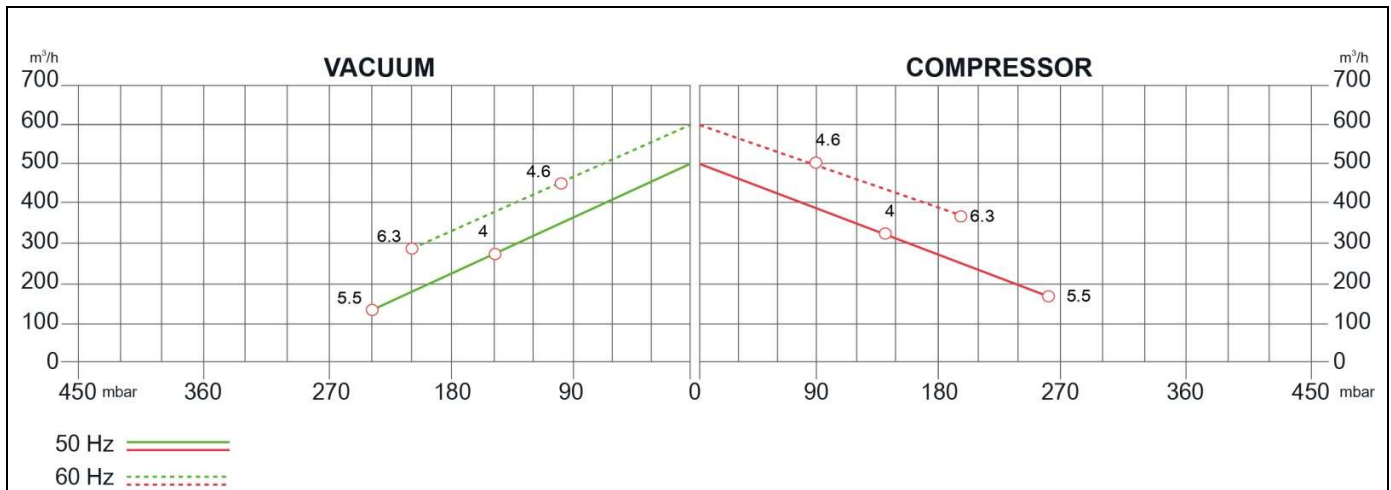

| MODEL            | A   | A'  | Bvv | C   | D   | E   | F   | G   | H   | H'  | J   | K   | L   | M   | N   | O  | ØP  | ØR | S   | T   | U      | V1      | V1'     | W  |
|------------------|-----|-----|-----|-----|-----|-----|-----|-----|-----|-----|-----|-----|-----|-----|-----|----|-----|----|-----|-----|--------|---------|---------|----|
| BX620 020 040 E3 | 426 | 426 | 410 | 154 | 290 | 325 | -   | -   | 197 | 162 | -   | 140 | 180 | -   | 205 | 53 | G2" | 15 | 4.5 | 130 | M8xX17 | M32X1.5 | M32X1.5 | 42 |
| BX620 020 055 E3 |     |     |     |     |     |     | 571 | 226 |     |     | 167 |     |     | 200 |     |    |     |    |     |     |        |         |         |    |

# SIDE CHANNEL BLOWERS

## BX 620 020 – E3 – Double Impeller – IE3

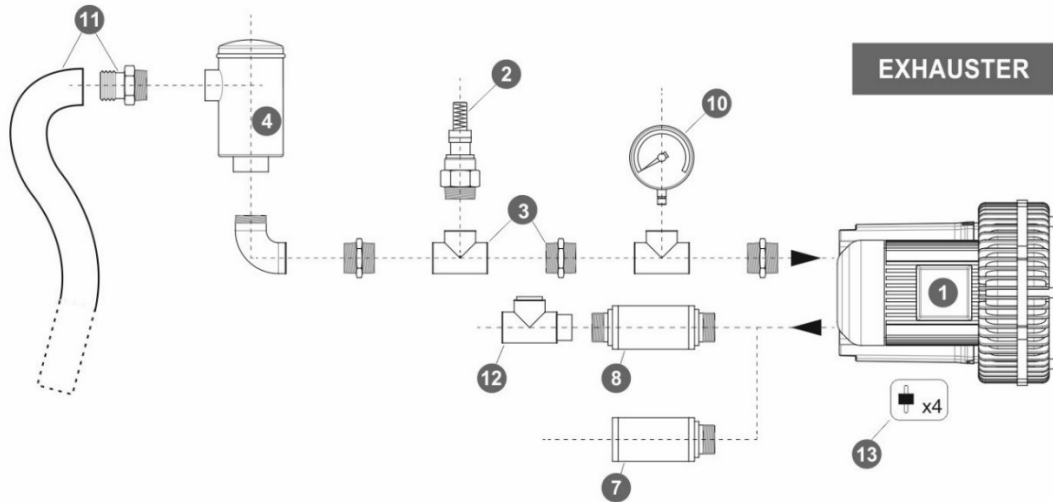

| Ref. # | Description   | Code   |
|--------|---|--|
| 1      | Side Channel Blower Double Impeller / Double Stage – Ø2" connection | BX 620 020__   |
| 2      | Safety Valve  | BXSV050AL03  |
| 3      | Installation kit safety valve                                       | BXKS05F050C  |
| 4      | In-Line filter  | Paper<br>Polyester<br>Stainless Steel 30 µ<br>Stainless Steel 60 µ |
| 5      | Cartridge filter  | BXCF050PA007   |
| 6      | Filter kit  | Nipple<br>Socket   |
| 7      | Final Silencer  | BXFS050ZP - BXFS050ZPR   |
| 8      | In-Line silencer  | BXIS050  |
| 9      | Indoor filter   | BXIF050ZP100   |
| 10     | Gauge   | BXMN06306<br>BXVG06306   |
| 11     | Sleeve + Hose clip kit  | BXSH050  |
| 12     | Check valve   | BXCV050AL  |
| 13     | Anti-vibration pins   | BXAV08   |

