

SIDE CHANNEL BLOWERS

BX 942 002 – 00/WT – Double Impeller – IE2



Construction of the ring blowers fans is based on the lateral ducts principle. The blowers can operate as either exhaust or compression fans and are designed for continuous service. The device is assembled directly on the motor shaft; all the rotating parts are dynamically balanced to ensure absolute absence of vibration. Full die-cast aluminum construction for maximum sturdiness and ease of handling. The characteristics data given here refer to the handling of gas with inlet temperature of 15°C, normal density of 1,23 kg/m³ and absolute pressure of 1023 mbar. Tolerance of ±10%. Max gas inlet temperature 40°.

Model	Freq. [Hz]	Power [kW]	Voltage [V]		Rated Current [A]		Max Airflow [m ³ /h]	Rated VACUUM [mbar]	Rated COMPRESSOR [mbar]	Noise [dB A]	Weight [kg]
			△	Y	△	Y					
BX942 020 150 00	50	7.5	345±415	600±720	16.7	9.6	520	-400	400	74	88
	60	8.6	380±480	660±720	17.3	10.0	620	-360	330	78	
BX942 020 200 00	50	11	345±415	600±720	28.0	16.2	520	-430	660	74	104
	60	12.6	380±480	660±720	29.0	16.7	620	-460	600	78	
BX942 020 250 00	50	15	345±415	600±720	32.5	18.8	520	-460	670	74	120
	60	17.3	380±480	660±720	34.5	19.9	620	-490	750	78	

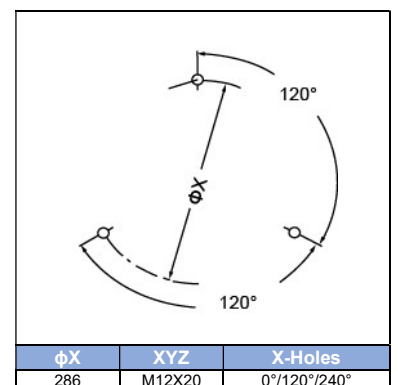
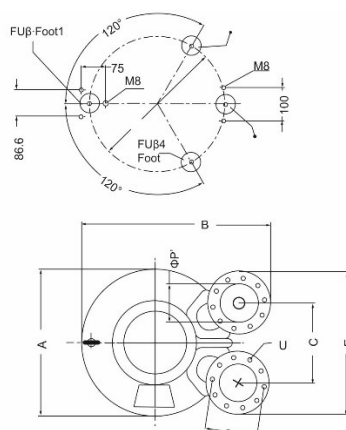
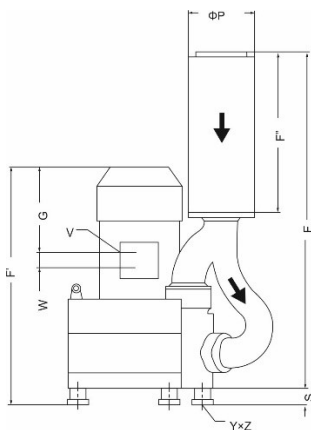
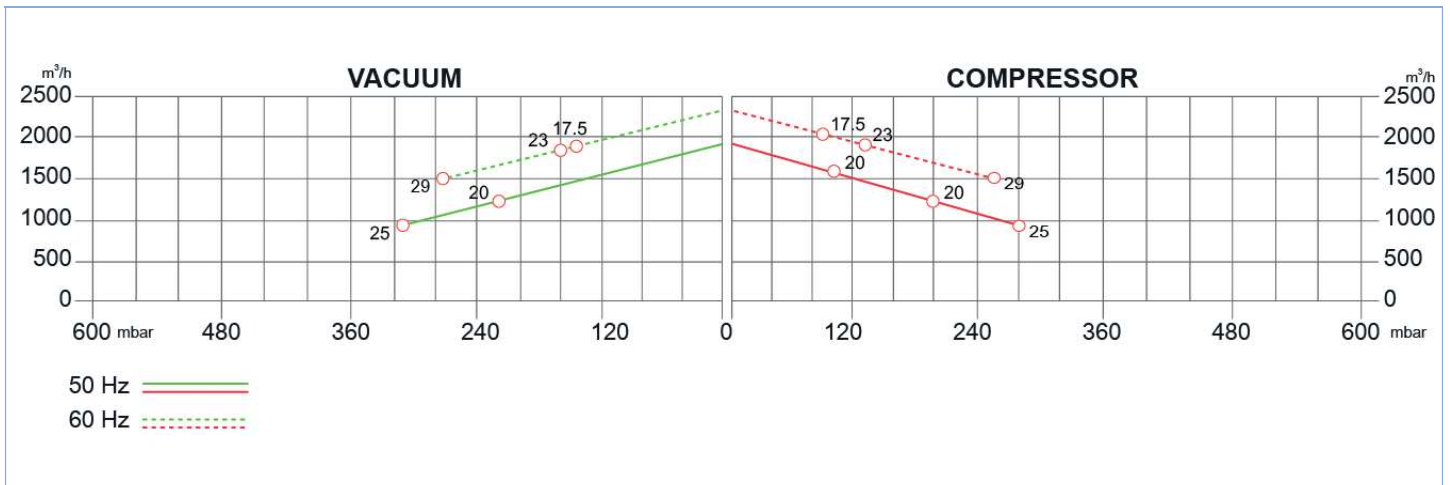

MODEL	A	B	B ₁	C	C'	D	E	F	F'	G	H	J	K	M	N	O	ØP	Q	ØR	S	T	U	V	W
BX942 020 150 00								752																
BX942020 200 00	615	663	19	207	15	360	415	786	345	358	197	533	39	230	150	G4"	140	15	79	117	M12X35	4XM40X1.5	54	
BX942 020 250 00								812																

SIDE CHANNEL BLOWERS

BX 942 002 – 00/WT – Double Impeller – IE2

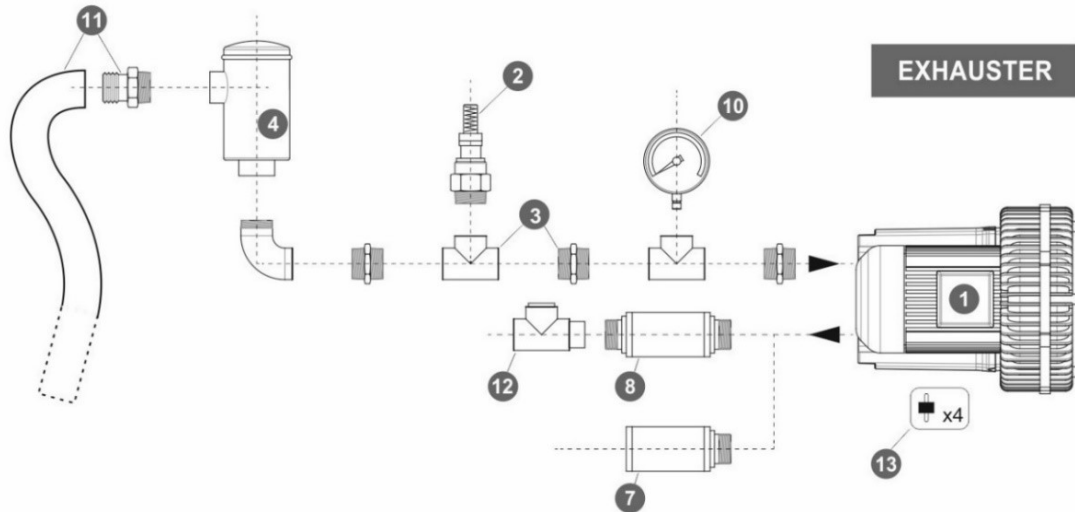

Ref. #	Description	Code
1	Side Channel Blower Double Impeller / Single Stage – Ø4" connection	BX 942 020__
2	Safety Valve	BXSV100AL02 BXSV100AL24
3	Installation kit safety valve	BXKS100100C BXKS10F100C
4	In-Line filter	Paper Polyester Stainless Steel 30 µ Stainless Steel 60 µ
5	Cartridge filter	BXCF100PA007
6	Filter kit	Nipple Socket
7	Final Silencer	BXFS100ZP – BXFS100ZPR
8	In-Line silencer	BXIS100
9	Indoor filter	-
10	Gauge	Pressure Vacuum
11	Sleeve + Hose clip kit	BXSH100
12	Check valve	BXCV100AL
13	Anti-vibration pins	BXAV12

