

BXCV – Check Valve – Clapet type

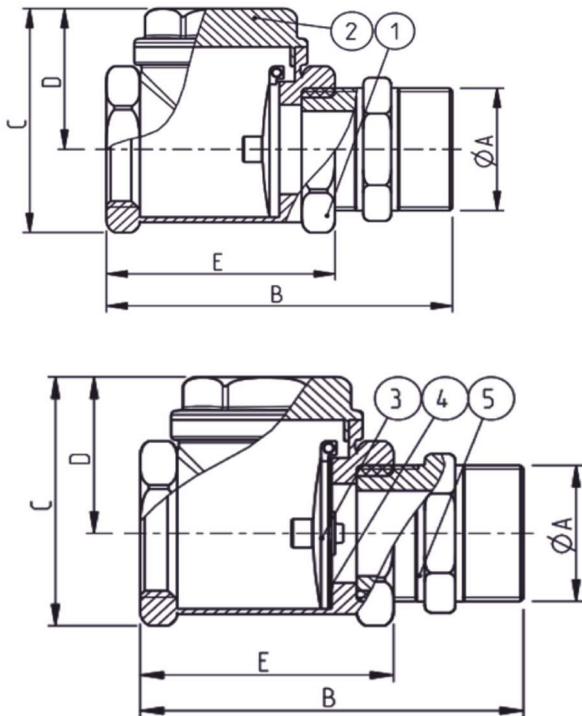

A check valve is a valve that normally allows fluid (liquid or gas) to flow through it in only one direction.

This valve is formed by a disc element secured by a guide and is pushed by a spring against the base of the valve, this condition occurs when there is not enough pressure to open the valve or there is a negative pressure and the valve remains closed, while with sufficient positive pressure the valve opens and the fluid is free to pass to the sides of the disc and pass it over.



Pos. #	Description
1	Valve body
2	Plug
3	Disk
4	Seal
5	Nipple (optional)

Code	A	B	C	D	E	Weight [kg]
BXCV032BR	1"1/4	115	76	46	72	0.85
BXCV040BR	1"1/2	130	86	53	81	1.15
BXCV050BR	2"	151	99	59	94	1.7
BXCV065BR	2"1/2	180	108	61	116	2.5
BXCV080BR	3"	-	-	-	-	-
BXCV100BR	4"	238	163	96	164	6